

PLAN ON NEW LOFT FLOOR STRUCTURE (1:100)

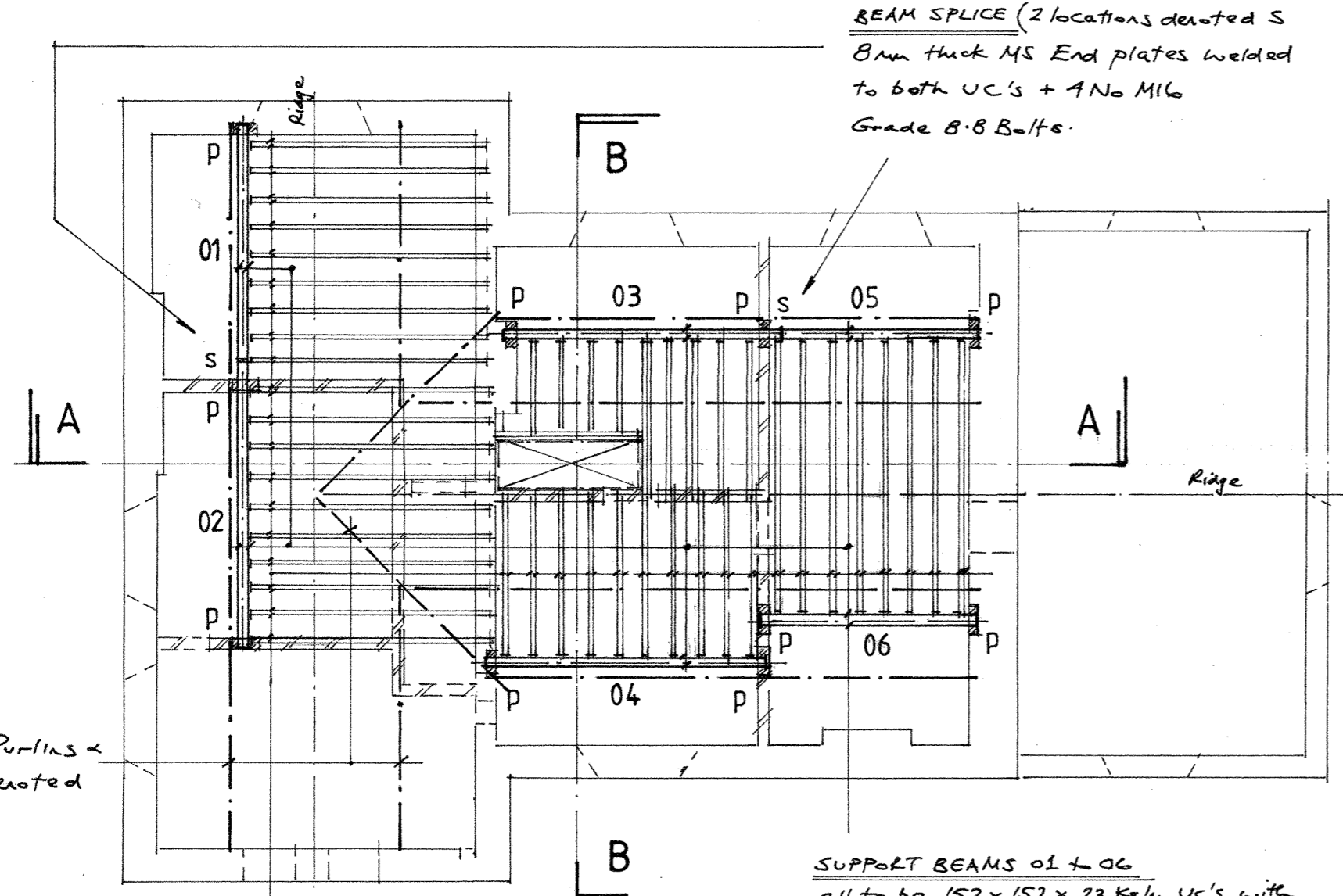

SECTION B-B (1:50)

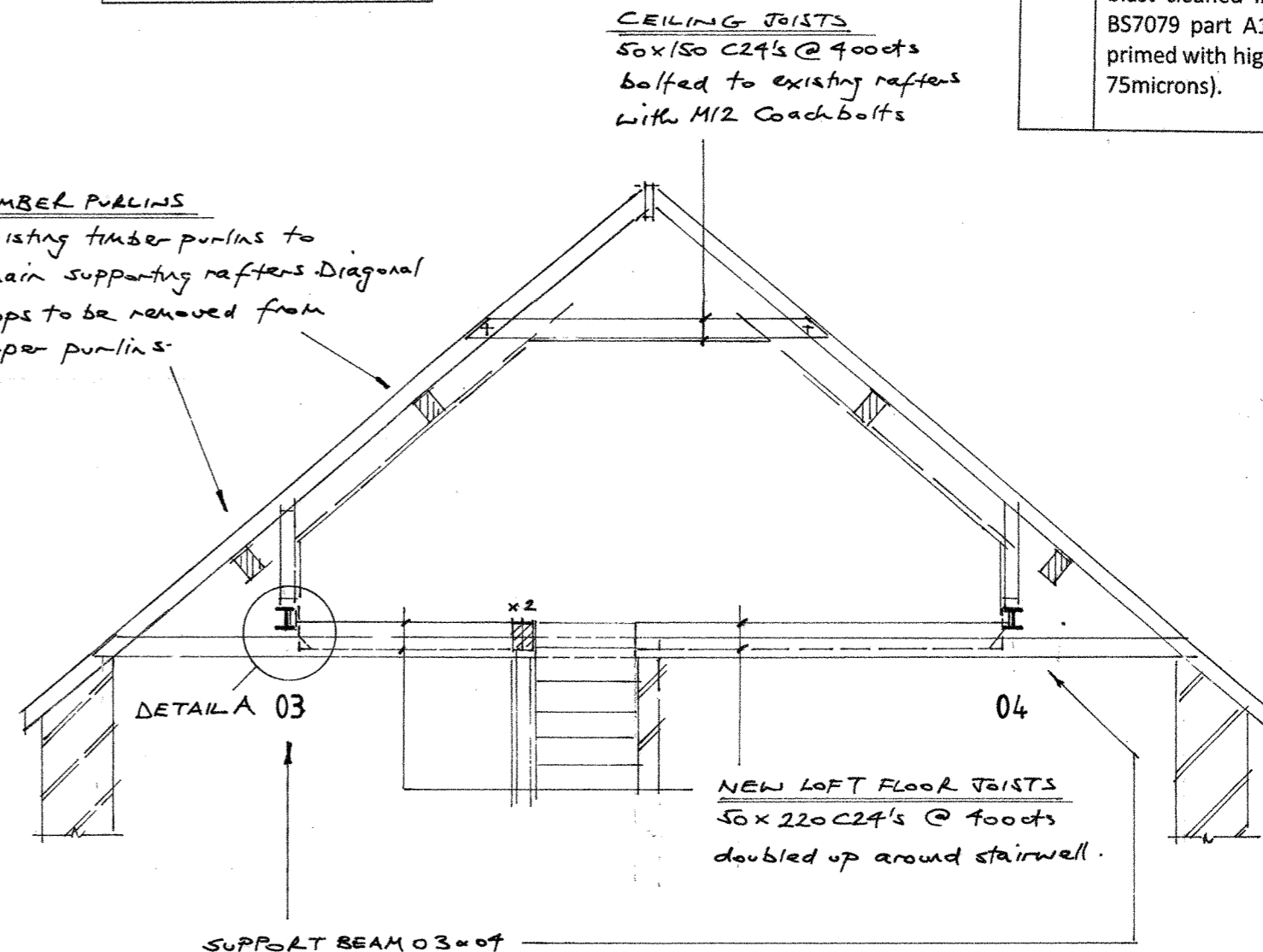

NOTES

- 1.0 This drawing is to read in conjunction with all current Architects drawings.
- 2.0 **DO NOT SCALE FROM THIS DRAWING.** All dimensions to be by site measurement.
- 3.0 Any discrepancies discovered on site that would alter details indicated on this drawing to be brought to the attention of M A Howard Associates Ltd for further instruction.
- 4.0 **STEELWORK** - all steelwork to be grade S355 blast cleaned in accordance with clause 720 of BS7079 part A1, preparation grade SA2.5, shop primed with high build zinc phosphate primer (dft 75microns).

NOTE:
All existing ridge props can be removed.

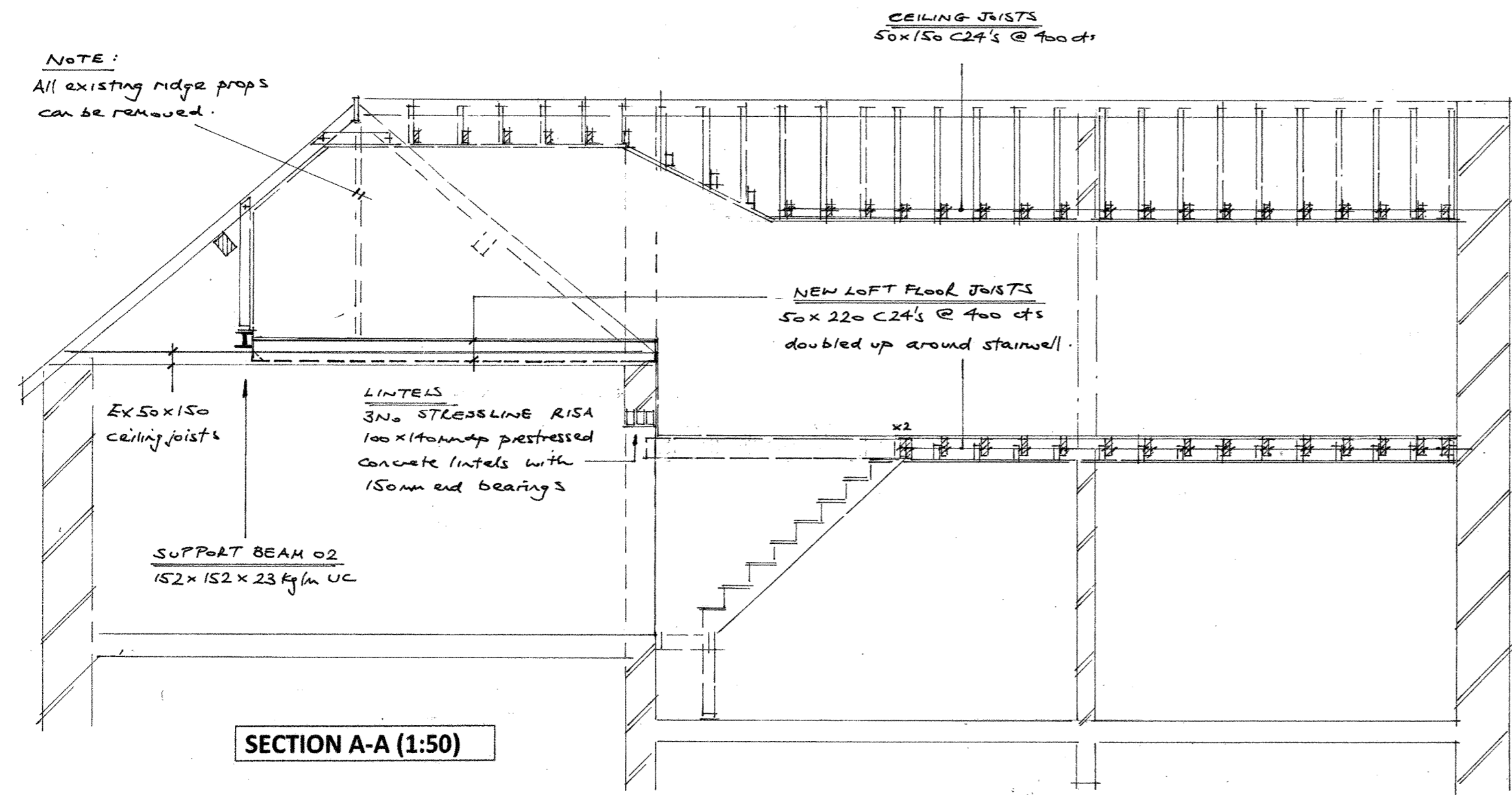

SECTION A-A (1:50)

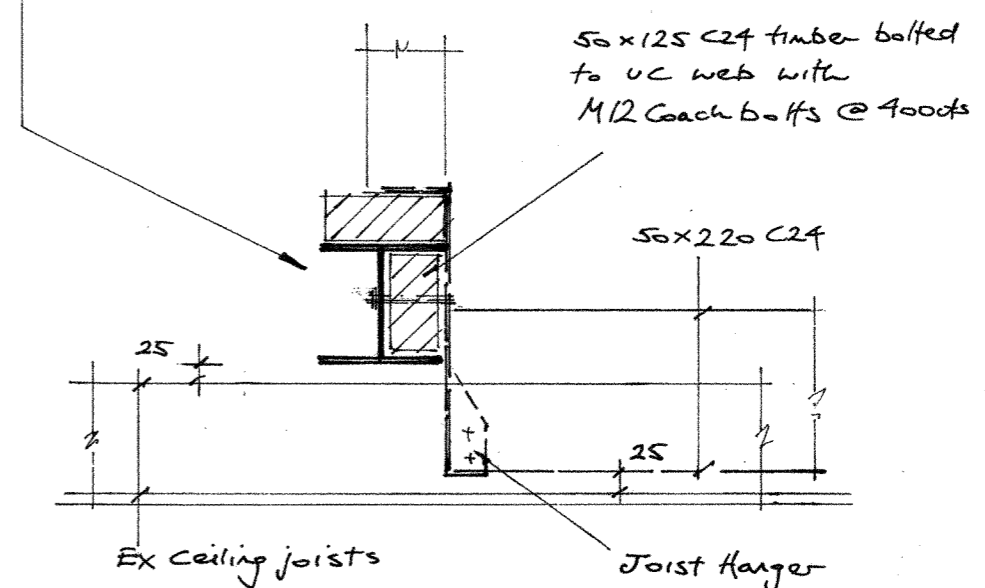

DETAIL A (1:10)

M. A. HOWARD ASSOCIATES LTD
Consulting Civil & Structural Engineers

188, Bedminster Down Road
BRISTOL, BS13 7AF

Tel (0117) 949 6749
e-mail: mark@mahoward.co.uk

Client: ROSS FAIRLEY

Job: INSPECTION HOUSE, STATION ROAD, BLAGDON, NORTH SOMERSET BS49 4NG
Proposed Loft Conversion

Drawing Title: STRUCTURAL WORKS

Drawing No: 52998/1 **Dec 2015**